

TACT SWITCH

SFKHH Series

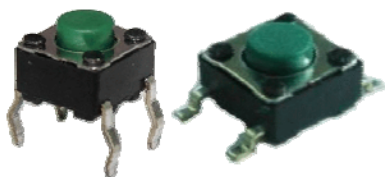

Features

- Dimensions of 6.0mm × 6.0mm contribute to smaller sets.
- Snap-in type, which can be directly mounted on PC board.
- Some of output terminals can be also used as jumper leads, thus making circuit design easy.



Applications -

- For operating various electronic equipment such as audio devices, office equipment, communication devices, measuring instruments, TVs, video recorders, etc.



Products Line

SF	K	HH	A	A	2	3	3	0
----	---	----	---	---	---	---	---	---

- FORWARD control number
- Operating Force: 1.100gf 2.160gf 3.260gf
- Height: 4:4.3mm 5:5.0mm 7:7.0mm 9:9.5mm
- Operating direction: 1. Horizontal 2. Vertical
- Type: FORWARD control number
- Type: FORWARD control number
- Model:
- K: K For Rohs N For HF



PCB mounting hole / land dimensions

DIP Type Dim	DIP Type Dim With Ground	SMT Type Dim	SMT Type Dim With Ground



Circuit diagram

Horizontal Type	DIP Type With Ground	SMT Type With Ground



Dimension

SFKHH DIP TYPE	Unit : mm

SFKHH DIP TYPE WITH GROUND

Unit : mm

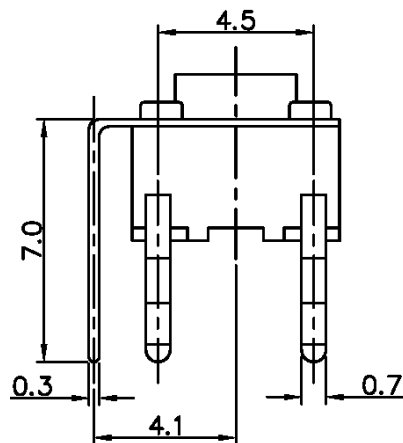
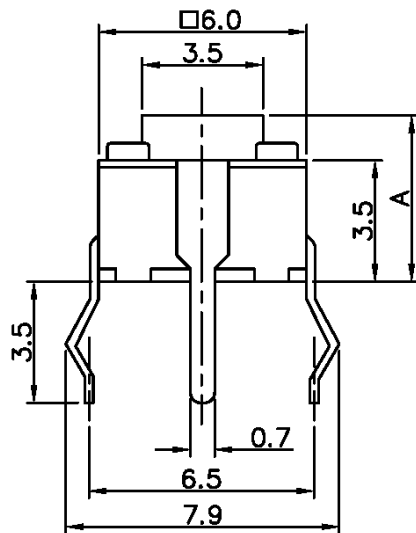
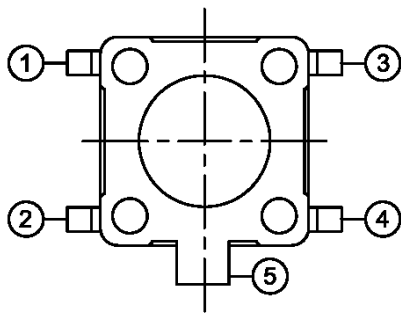

SFKHH SMT TYPE

Unit : mm

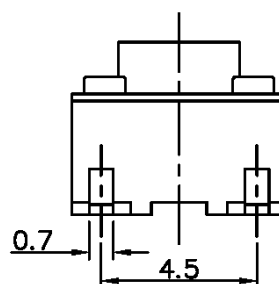
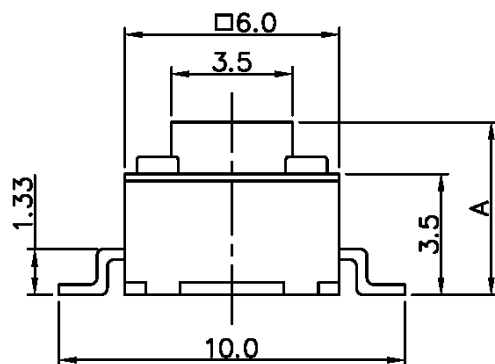
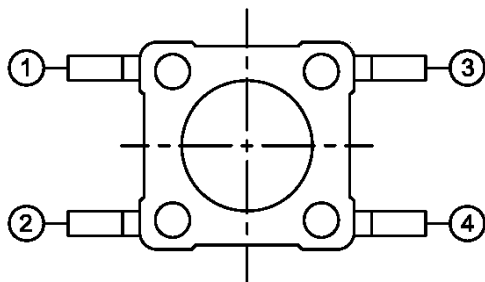

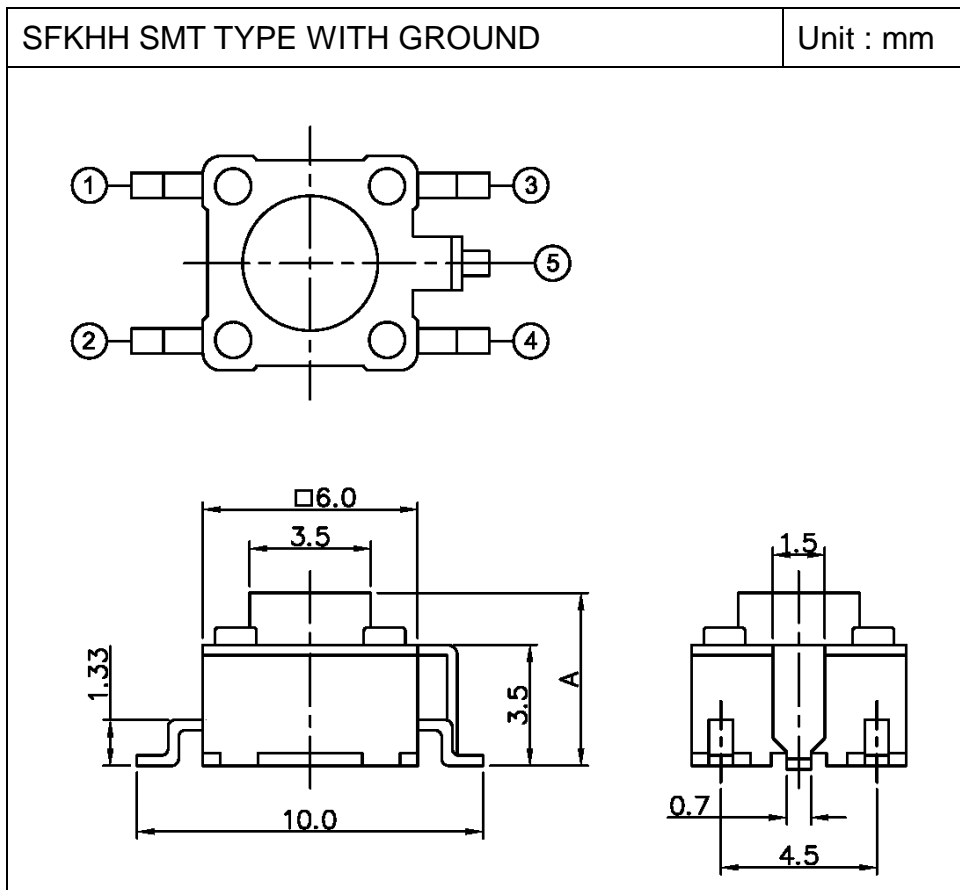

💡 Packing Specifications

BULK

Number of packages(pcs.)	1 Bag	2000
	1 carton	20,000

REEL

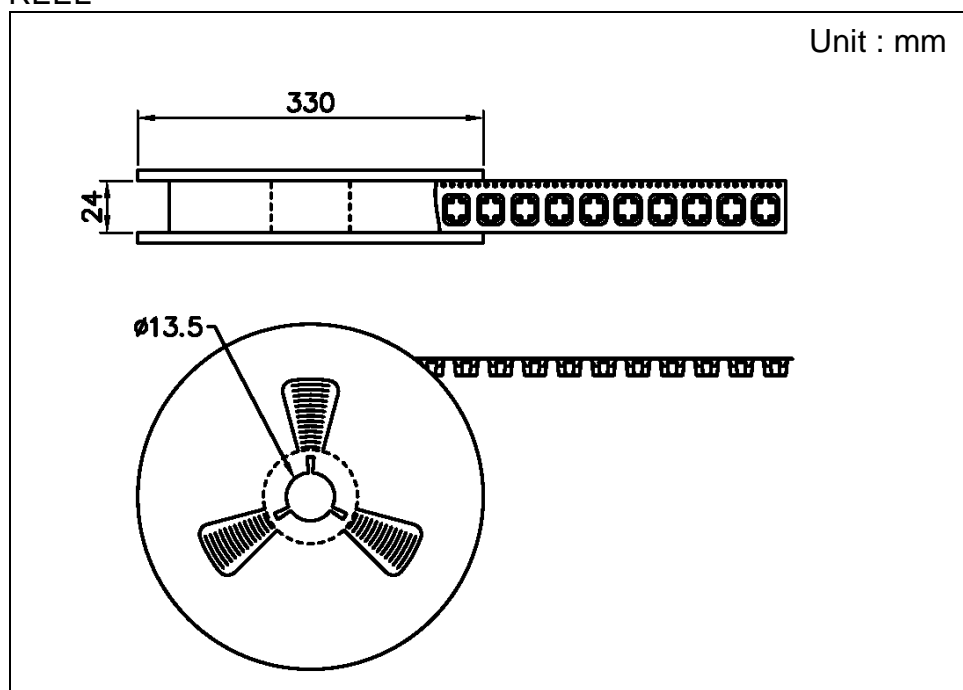

Number of packages(pcs.)	1 Reel	1000
		750
	1 carton	10,000
		7,500