

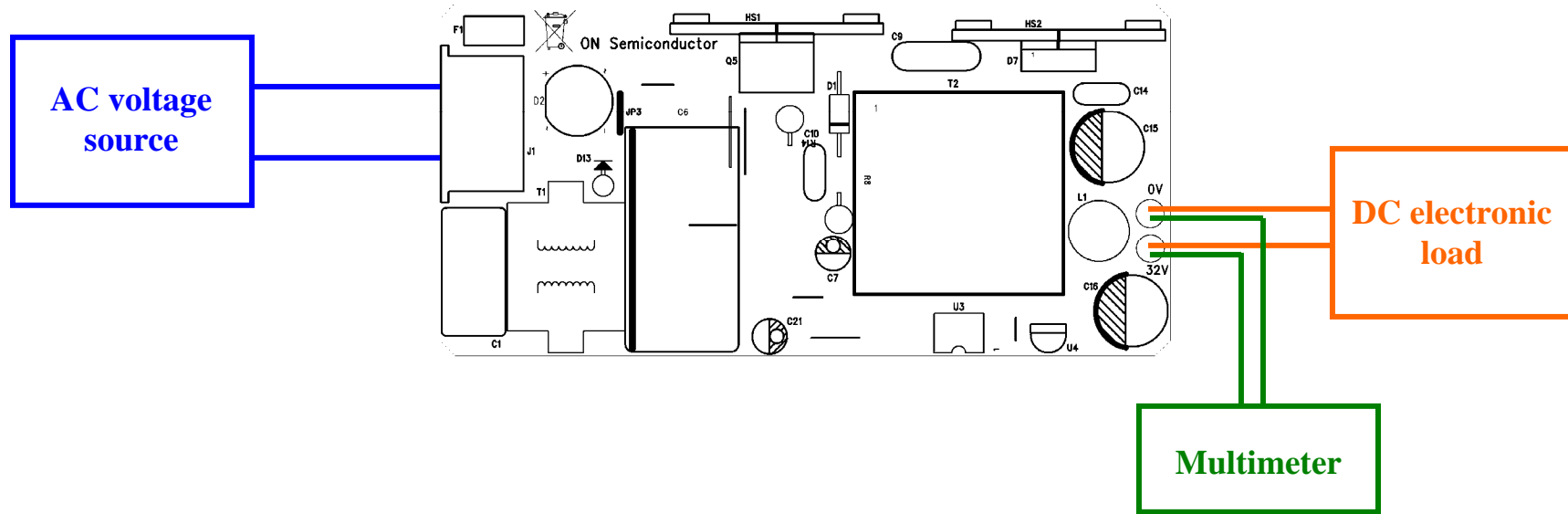

Test Procedure for the NCP1237PRINTGEVB



Required Equipment

AC voltage source
DC electronic load
Multimeter

**Test Procedure:**

1. Connect the test setup as shown above.
2. Set up the load for 1 A. Enable the load.
3. Apply an input voltage, $V_{IN} = 265 \text{ Vac}$, 50 Hz. Verify that the output voltage is 32 V +/-0.5 V.
4. Disable the load. Verify that the output voltage is still 32 V +/-0.5 V.
5. Enable the load. Change the input voltage to 0 V.
6. Apply an input voltage, $V_{IN} = 85 \text{ Vac}$, 60 Hz. Verify that the output voltage is 32 V +/-0.5 V.
7. Disable the load. Verify that the output voltage is still 32 V +/-0.5 V.
8. Enable the load.
9. Turn off the AC source.

Caution: The bulk capacitor C6 stays charged even after the board is unplugged from the AC source.
Manipulate the board with caution.